

# Multimar EDI-36B-10 / EDI-36B-20 / EMD-36B-10 / EMD-36B-20 / EMD-36B-10D / EMD-36B-20D



## Indicator Gauge

### FEATURES

- Friction-free, zero-backlash measuring anvil holder for high measuring accuracy
- Parallel spring-loaded system for repeatable measuring force
- User-friendly and ergonomic:
  - Table surface can be tilted and clamped between 0° and 90°
  - Adjustable lifting of movable probe
- Adjustable measuring force
- **Data interface:** Digimatic, RS232C, USB
- **Energy supply:** Battery operation
- **Package contains:** set of jaws JW-9, instruction manual



### Application:

- For measuring internal and external diameters, centering edges, narrow shoulders and recesses
- "T"-plates give a diameter reading directly across the diameter
- A third contact may be used as a side-stop or centralizer

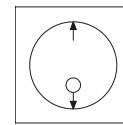

without centralizer

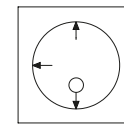

with centralizer

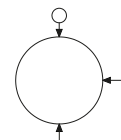

external

### TECHNICAL DATA

Order no.	2051693	2051695	2051863	2051873	2051864	2051874
Product type	EDI-36B-10	EDI-36B-20	EMD-36B-10	EMD-36B-20	EMD-36B-10D	EMD-36B-20D
Application range outside	mm 6 –127	6 –222	6 –127	6 –222	6 –127	6 –222
Application range outside	inch .25 –5"	.25 –8.75"	.25 –5"	.25 –8.75"	.25 –5"	.25 –8.75"
Application range inside	mm 19 –89	19 –197	19 –89	19 –197	19 –89	19 –197
Application range inside	inch .75 –3.5"	.75 –7.75"	.75 –3.5"	.75 –7.75"	.75 –3.5"	.75 –7.75"
Resolution	mm 0.0002, 0.0005, 0.001, 0.002, 0.005, 0.01, 0.02	0.0005, 0.001, 0.005				
Resolution	inch .00001", .00002", .00005", .0001", .0002", .0005", .001"	.00002", .00005", .0001", .0005"				
Measuring force, adjustable	N	0 –35				
Travel of moveable anvil, adjustable	mm	6 –10				
Travel of moveable anvil, adjustable	inch	.25 –.40"				
Indicating instrument (included in package)	2034201 µMaxµm II		2033109 Maxµm III		2033119 Maxµm III	

Order no.	Mounting hole
2051693	Indicator back mounted
2051695	Indicator back mounted
2051863	Indicator back mounted
2051873	Indicator back mounted
2051864	Indicator back mounted
2051874	Indicator back mounted

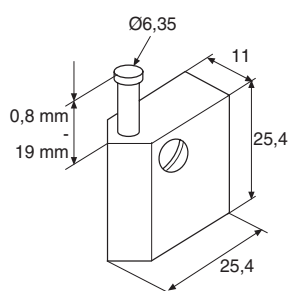

JW-9; JW-69; JW-58

### ACCESSORIES

Order no.	Product name	Product type
2220455	Jaw set of measuring elements, with measuring anvils made of carbide	JW-58
2225702	Measuring anvil for JW-9, made of steel	PS-55
2225676	Separate measuring anvils for JW-58 / 2003211 measuring elements, made of carbide	PS-226

# Multimar M36B-10 / M36B-20 / 36B-10M / 36B-20M

## Indicator Gage

### FEATURES

- Friction-free, zero-backlash measuring anvil holder for high measuring accuracy
- Parallel spring-loaded system for repeatable measuring force
- User-friendly and ergonomic:
  - Table surface can be tilted and clamped between 0° and 90°
  - Adjustable lifting of movable probe
- Adjustable measuring force



### Application:

- For measuring inside and outside dimensions: diameters, lengths, distances between bores, offsets, etc.
- Measurement in bores, outside surfaces, recesses, centering shoulders, etc.

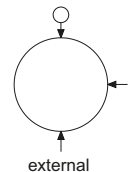
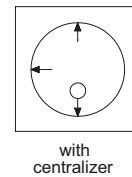
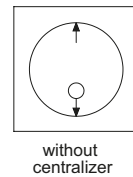

### TECHNICAL DATA

Order no.		2003200	2003201	2050644	2050648
Product type		M36B-10	M36B-20	36B-10M	36B-20M
Application range outside	mm	6.5 – 125	6.5 – 222	6.5 – 125	6.5 – 222
Application range outside	inch	.25 – 5"	.25 – 8.75"	.25 – 5"	.25 – 8.75"
Application range inside	mm	20 – 130	20 – 197	20 – 130	20 – 197
Application range inside	inch	.75 – 5.1"	.75 – 7.75"	.75 – 5.1"	.75 – 7.75"
Graduation value	mm				0.002
Measuring force, adjustable	N			0 – 35	
Travel of moveable anvil, adjustable	mm			6 – 10 mm	
Travel of moveable anvil, adjustable	inch		.25 – .40"		
Indicating instrument (included in package)			None		IDS-317 Indicator (Q11-RC)



1087 BR



1087 BRI

Order no.	Mounting hole	Mounting hole
		mm
2003200		8
2003201		8
2050644	Indicator back mounted	
2050648	Indicator back mounted	

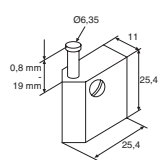

JW-9; JW-69; JW-58

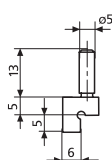

844 Ta

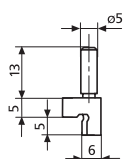

844 Ti

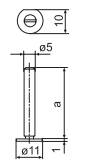

844 Tb

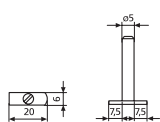

844 Tc

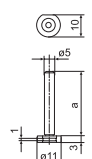

844 Td

### ACCESSORIES

Order no.	Product name	Quantity unit	Product type
4337662	Digital indicator, 0.0005 mm, 12.5 mm		1087 BR
4337664	Digital indicator, 0.0005 mm, 12.5 mm		1087 BRI
2220461	Set of measuring elements with measuring anvils made of hardened steel, for metric version M36B-10 / M36B-20	Set (=3 Pc.)	JW-69
2225694	Separate measuring anvils for JW-69M / 2220461 measuring elements, Made of hardened steel	Piece	PS-276
2220455	Jaw set of measuring elements, with measuring anvils made of carbide	Set (=3 Pc.)	JW-58
2225676	Separate measuring anvils for JW-58 / 2003211 measuring elements, made of carbide	Piece	PS-226
4500050	Shoulder anvils, flat, hardened steel	Pair	844 Ta
4500055	Shoulder anvils, spherical, hardened steel	Pair	844 Ti
4503015	Measuring anvils with measuring blades, Platelet diameter 11 mm, Adjustment range 0 – 20 mm	Piece	844 Tb
4503114	Measuring anvils with measuring blades, Platelet length 20 mm, Adjustment range 0 – 20 mm	Piece	844 Tc
4503017	Anvils with round measuring faces, Diameter 11 mm, Adjustment range 0 – 20 mm	Piece	844 Td

# Multimar 36B-10 / 36B-20

## Indicator Gage

### FEATURES

- Friction-free, zero-backlash measuring anvil holder for high measuring accuracy
- Parallel spring-loaded system for repeatable measuring force
- User-friendly and ergonomic:
  - Table surface can be tilted and clamped between 0° and 90°
  - Adjustable lifting of movable probe
- Adjustable measuring force
- **Data interface:** none
- **Package contains:** set of jaws JW-9, instruction manual



### Application:

- For measuring internal and external diameters, centering edges, narrow shoulders and recesses
- "T"-plates give a diameter reading directly across the diameter. A third contact may be used as a side-stop or centralizer

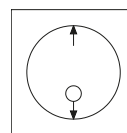

without centralizer

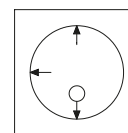

with centralizer

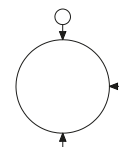

external

### TECHNICAL DATA

Order no.		2050643	2050647
Product type		36B-10	36B-20
Application range outside	inch	.25 - 5"	.25 - 8.75"
Application range inside	inch	.75 - 3.5"	.75 - 7.75"
Graduation value	inch	.0001"	
Measuring force, adjustable	N	0 - 35	
Travel of moveble anvil, adjustable	inch	.25 - .40"	
Indicating instrument (included in package)		2011593 Indicator (32I-RC)	

Order no.	Mounting hole
2050643	Indicator back mounted
2050647	Indicator back mounted

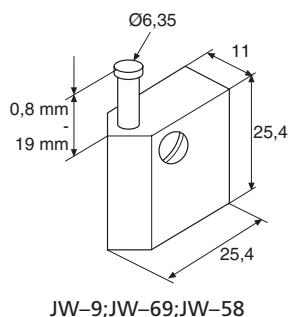

JW-9; JW-69; JW-58

### ACCESSORIES

Order no.	Product name	Product type
2220455	Jaw set of measuring elements, with measuring anvils made of carbide	JW-58
2225702	Measuring anvil for JW-9, made of steel	PS-55
2225676	Separate measuring anvils for JW-58 / 2003211 measuring elements, made of carbide	PS-226

# Multimar EDI-36B-9 / EDI-36B-19 / EMD-36B-9D / EMD-36B-19D



## Indicator Gage

### FEATURES

- Friction-free, zero-backlash measuring anvil holder for high measuring accuracy
- Parallel spring-loaded system for repeatable measuring force
- User-friendly and ergonomic:
  - Table surface can be tilted and clamped between 0° and 90°
  - Adjustable lifting of movable probe
- Adjustable measuring force
- **Data interface:** Digimatic, RS232C, USB
- **Energy supply:** Battery operation
- **Package contains:** set of jaws JW-9, instruction manual

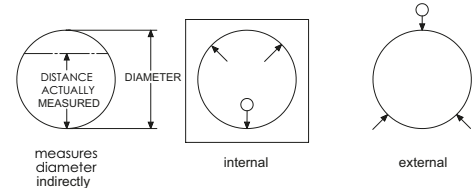

### Application:

- For measuring internal and external diameters, centering edges, narrow shoulders and recesses

### TECHNICAL DATA

Order no.		2051696	2051694	2051881	2051871
Product type		EDI-36B-9	EDI-36B-19	EMD-36B-9D	EMD-36B-19D
Application range outside	mm	8 –127	8 –241	8 –127	8 –241
Application range outside	inch	.312 –5"	.312 –9.5"	.312 –5"	.312 –9.5"
Application range inside	mm	21 –117	21 –229	21 –117	21 –229
Application range inside	inch	.812 –4.625"	.812 –9"	.812 –4.625"	.812 –9"
Resolution	mm	0.0002, 0.0005, 0.001, 0.002, 0.005, 0.01, 0.02		0.0005, 0.001, 0.005	
Resolution	inch	.00001", .00002", .00005", .0001", .0002", .0005", .001"		.00002", .00005", .0001", .0005"	
Measuring force, adjustable	N	0 –35			
Travel of moveable anvil, adjustable	mm	6 –10 mm			
Travel of moveable anvil, adjustable	inch	.25 –.40"			
Indicating instrument (included in package)		2034201 µMaxµm II		2033145 MaxumIII (special 4:5 ratio)	

Order no.	Mounting hole
2051696	Indicator back mounted
2051694	Indicator back mounted
2051881	Indicator back mounted
2051871	Indicator back mounted

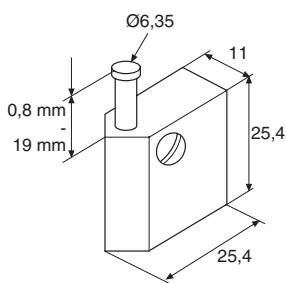

JW-9; JW-69; JW-58

### ACCESSORIES

Order no.	Product name	Product type
2220455	Jaw set of measuring elements, with measuring anvils made of carbide	JW-58
2225702	Measuring anvil for JW-9, made of steel	PS-55
2225676	Separate measuring anvils for JW-58 / 2003211 measuring elements, made of carbide	PS-226

# Multimar 36B-19 / 36B-9

## Indicator Gage

### FEATURES

- Friction-free, zero-backlash measuring anvil holder for high measuring accuracy
- Parallel spring-loaded system for repeatable measuring force
- User-friendly and ergonomic:
  - Table surface can be tilted and clamped between 0° and 90°
  - Adjustable lifting of movable probe
- Adjustable measuring force
- **Data interface:** none
- **Package contains:** set of jaws JW-9, instruction manual

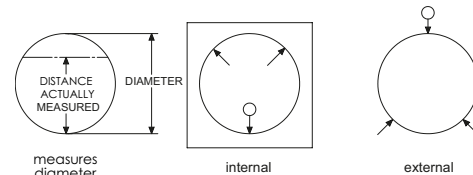

### Application:

- For measuring internal and external diameters, centering edges, narrow shoulders and recesses

### TECHNICAL DATA

Order no.	2050645		2050652	
Product type		36B-19		36B-9
Application range outside	inch	.312 -9.5"		.312 -5"
Application range inside	inch	.812 -9"		.812 -4.625"
Graduation value	inch		.0001"	
Measuring force, adjustable	N		0 -35	
Travel of moveble anvil, adjustable	inch		.25 - .40"	
Indicating instrument (included in package)			IDT-188 Indicator (32K-RC)	

Order no.	Mounting hole
2050645	Indicator back mounted
2050652	Indicator back mounted

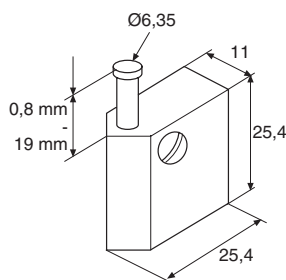

JW-9; JW-69; JW-58

### ACCESSORIES

Order no.	Product name	Product type
2220455	Jaw set of measuring elements, with measuring anvils made of carbide	JW-58
2225702	Measuring anvil for JW-9, made of steel	PS-55
2225676	Separate measuring anvils for JW-58 / 2003211 measuring elements, made of carbide	PS-226

# Multimar 36B-19M / 36B-9M

## Indicator Gage

### FEATURES

- Friction-free, zero-backlash measuring anvil holder for high measuring accuracy
- Parallel spring-loaded system for repeatable measuring force
- User-friendly and ergonomic:
  - Table surface can be tilted and clamped between 0° and 90°
  - Adjustable lifting of movable probe
- Adjustable measuring force
- **Data interface:** none
- **Package contains:** set of jaws JW-9, instruction manual

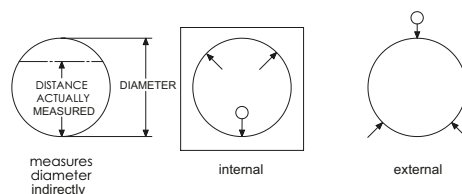
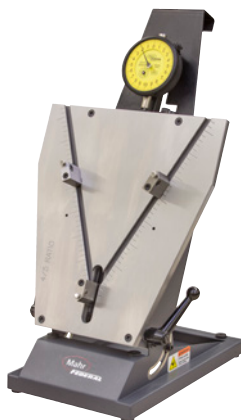

### Application:

- For measuring internal and external diameters, centering edges, narrow shoulders and recesses

### TECHNICAL DATA

Order no.	2050646		2050653	
Product type	36B-19M		36B-9M	
Application range outside	mm	8 -241	8 -127	
Application range inside	mm	21 -229	21 -117	
Graduation value	mm	0.002		
Measuring force, adjustable	N	0 -35		
Travel of moveable anvil, adjustable	mm	6 -10 mm		
Indicating instrument (included in package)	IDS-318 Indicator (Q21-RC)			

Order no.	Mounting hole
2050646	Indicator back mounted
2050653	Indicator back mounted

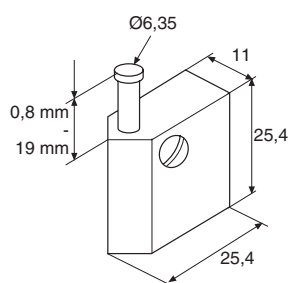

JW-9; JW-69; JW-58

### ACCESSORIES

Order no.	Product name	Product type
2220455	Jaw set of measuring elements, with measuring anvils made of carbide	JW-58
2225702	Measuring anvil for JW-9, made of steel	PS-55
2225676	Separate measuring anvils for JW-58 / 2003211 measuring elements, made of carbide	PS-226

# Multimar 36B-10-VT / 36B-20-VT

## Indicator Gauge



### FEATURES

- Friction-free, zero-backlash measuring anvil holder for high measuring accuracy
- Parallel spring-loaded system for repeatable measuring force
- User-friendly and ergonomic:
  - Table surface can be tilted and clamped between 0° and 90°
  - Adjustable lifting of movable probe
- Adjustable measuring force
- **Data interface:** Digimatic, RS232C, USB, Wireless
- **Energy supply:** Battery operation
- **Package contains:** set of jaws JW-9, instruction manual

### Application:

- For measuring internal and external diameters, centering edges, narrow shoulders and recesses
- "T"-plates give a diameter reading directly across the diameter. A third contact may be used as a side-stop or centralizer
- "V"-plates are self-centralizing. Three jaws are used and the measurement is of the distance between the sensitive contact and the chord formed by the two reference contacts. This measurement bears a direct relationship to the diameter and compensation is made by a special ratio indicator so diameter is read directly. Used to inspect parts with odd number lobing conditions

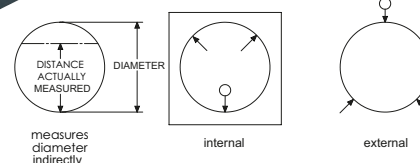

### TECHNICAL DATA

Order no.		2061657	2061658
Product type		36B-10-VT	36B-20-VT
Application range outside	mm	6 –127	6 –222
Application range inside	mm	19 –89	19 –197
Resolution	mm	0.0005, 0.001, 0.002, 0.005, 0.01	
Resolution	inch	.00002", .00005", .0001", .0002", .0005"	
Measuring force, adjustable	N	0 –35	
Travel of moveable anvil, adjustable	mm	6 –10 mm	
Travel of moveable anvil, adjustable	inch	.25 –.40"	
Indicating instrument (included in package)		4337662 (1087 BR)	

Order no.	Mounting hole	Mounting hole
	inch	mm
2061657	Indicator back mounted	8
2061658	Indicator back mounted	8

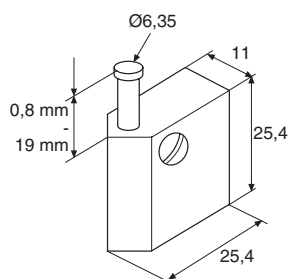

JW-9; JW-69; JW-58

### ACCESSORIES

Order no.	Product name	Product type
2220455	Jaw set of measuring elements, with measuring anvils made of carbide	JW-58
2225702	Measuring anvil for JW-9, made of steel	PS-55
2225676	Separate measuring anvils for JW-58 / 2003211 measuring elements, made of carbide	PS-226